

## Rodding Eye



- Available with a square frame in 4 standard sizes.
- Vertical outlet.
- Complete with 4 fixing points.
- Available with Flat Plate, Chequer Plate and Tile Inset Covers.
- Available in 304 and 316 stainless steel.
- Includes rubber mounting gasket

### Description

Rodding eyes are locked and sealed access covers installed downstream of drainage gullies, or at any convenient point in a drainage system, to facilitate easy access for cleaning, blockage removal and effluent testing..

### Technical description

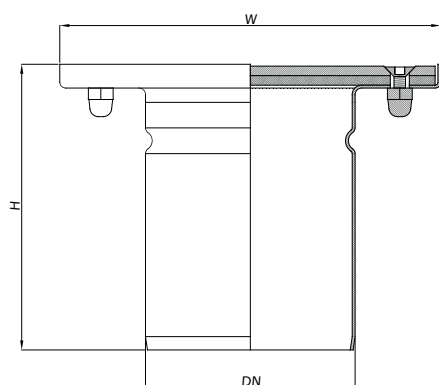

BK RC Rodding eye	150	200	250	300
W	150mm x 150mm	200mm x 200mm	250mm x 250mm	300mm x 300mm
H	minimum 150mm	minimum 150mm	minimum 150mm	minimum 150mm
DN	50mm/75mm/ 110mm	50mm/75mm/ 110mm/160mm	50mm/75mm/ 110mm/160mm	50mm/75mm/ 110mm/160mm/200mm



Flat Plate Cover



Chequer Plate Cover



Tile Inset Cover