



BK AQUADRAIN



**Stainless steel drainage
& industrial components**



info@bkaquadrain.co.uk

0114 553 9593





BK AQUADRAIN

B&K Group design & manufacture standard modular, & bespoke stainless steel drainage & industrial components. Operating from a state of the art European facility producing high quality 304 & 316 grade stainless steel building products, B&K understand that a high quality product range demands the best of customer & site support from design & preparation through to installation, operation & completion.

Supplied through BK Aquadrain in the UK & Ireland, the B&K stainless steel drainage range contains products to meet all industrial & civil construction needs across a wide variety of market sectors, such as food & beverage production & processing, pharmaceuticals, engineering, water treatment, car parks, warehouses & swimming pools. Any environment where the rapid & efficient removal of surface process liquids, corrosive or otherwise, or cleaning water is required. All B&K drainage systems are chemically descaled and passivated to enhance natural corrosion resistance.

- Drainage channels - box & slot channels
- Gullies - 1 & 2 part, horizontal & vertical, including specific hygienic & lockable options & rodding eyes
- Floor pans
- Inspection chamber covers

B&K Group are manufacturing members of European Hygienic Engineering & Design Group (EHEDG).



The BK Aquadrain industrial components range ensures customers stainless steel civil construction needs are met from a single source, whether standard or bespoke, to meet site-specific requirements.

- Kerbs
- Coving
- Balustrades & bump bars
- Stainless steel baths
- Stainless steel furniture





Drainage Channels

BK Aquadrain drainage channels provide first-rate hygienic properties, easy access for cleaning, longevity, and excellent flow capacity.

A broad range of 304 & 316 channel profiles to allow the efficient removal & transfer of any volume of liquids for manufacturing & cleaning processes. Channels can be manufactured with or without gratings to suit the expected traffic & cleaning regimes, with modular cost-effective solutions for straightforward requirements, or site specific bespoke options. Bespoke design can consider specific layouts & flow rates, together with hygiene & contamination security considerations.

Box channels are available with a range of cover options including slip resistant, plain ladder & flat plate, & in either a flat or V profile for increased flow rates & with a choice of flange details dependent on fitting position & the floor finish.

Slot channels can be provided in a variety of profiles to suit the floor finish, flow rate & ease of cleaning required.



Box Channels



- Available in several standard widths (external dimensions) from 100mm to 1000mm.
- Available with Slip Resistant Mesh, Plain Ladder and Flat Plate covers.
- Complete with fixing tangs and stability braces.
- Includes rubber joint gaskets.
- Available with Flat or V shaped profiles.
- Available with standard, tile and wall flange details.
- Available in 304 and 316 stainless steel.

Technical description

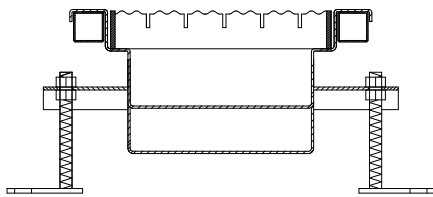
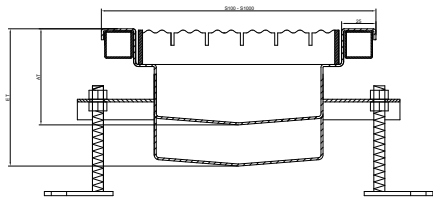

Flat Profile

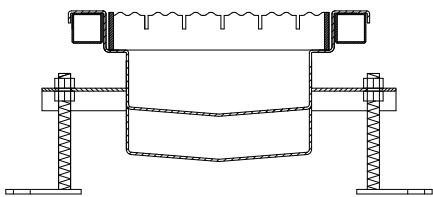

V Profile

Flange details

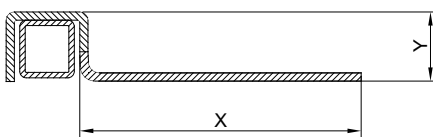

Description

Box channels are suitable for a wide range of industrial and commercial environments, allowing rapid removal and management of large volumes of process liquids and cleaning water. The channels come with under welded braces to ensure stability, fixing tangs to ensure firm fixing into the back-fill medium and with a one or two-part gully as specified. The profiles are available in either flat or V profile for increased flow rates and three flange details dependent on their fitting position and the floor finish.

| Box Channel BK KA S | |
|---------------------|----------------|
| AT | min 50mm |
| ET | customer order |
| S | 100-1000mm |

Flange Detail



Slip resistant



Standard



Plain ladder



Tile



Plate



Wall



Slot Channels

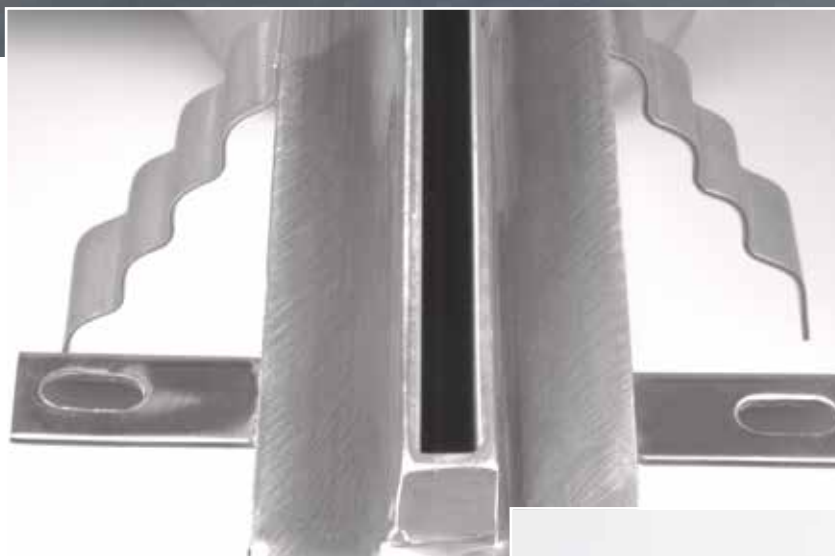

Slot Channels



- Designed & manufactured to site specific customer requirements.
- Available in 20mm or 8mm slot widths.
- Complete with fixing tangs.
- Available in 304 and 316 stainless steel.
- Available in 6 profile shapes dependent on floor finish, flow rate and ease of cleaning required

Description

Slot channels provide more discreet drainage and avoid the necessity for gratings. They are suitable for industrial and commercial locations where the trafficking or cleaning of gratings may be problematic.

Technical description

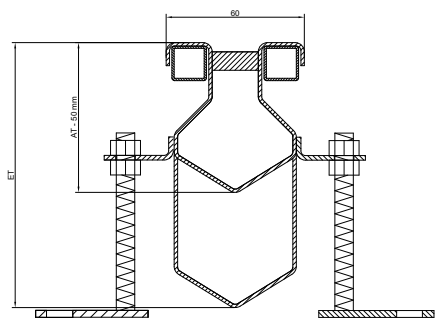
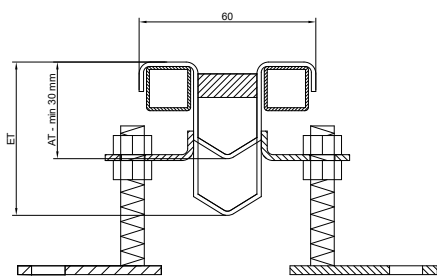

| Slot channel KA S | Standard |
|-------------------|----------------|
| AT | min 30mm |
| ET | customer order |
| S | 60mm |

| Slot channel KA S | Omega |
|-------------------|----------------|
| AT | min 65mm |
| ET | customer order |
| S | 60mm |

Profile



S60

Edge: 20mm Slot: 20mm
Material Thickness: 1.5mm



S50

Edge: 20mm Slot: 10mm
Material Thickness: 1.5mm



S70

Edge: 25mm Slot: 20mm
Material Thickness: 1.5mm

Flange details

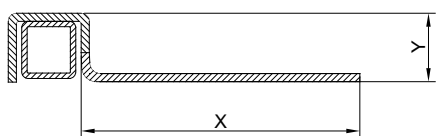

Fixed flange

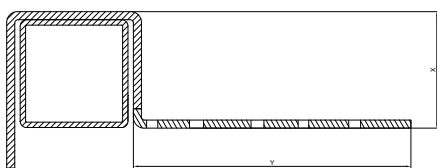

Lower part fixed flange



S14

Edge: 3mm Slot: 8mm
Material Thickness: 1.5mm



S14

Edge: 3mm Slot: 8mm
Material Thickness: 1.5mm



S8

Flat range connection
Slot: 8mm
Material Thickness: 1.5mm



Gullies

Gullies can be stand alone items for smaller rooms where liquid contamination is minimal, or be designed as part of an entire surface drainage system in combination with one of the broad range of B&K Aquadrain channel systems. All are supplied with removable & easy-to-clean water traps & silt baskets, & a range of gratings & covers for all applications & applied loads.

The gully range is designed to cater for a wide variety of flow rates in industrial, commercial and leisure applications, ensuring fast & efficient collection & transfer of liquids. Gullies are available as one or two part, vertical or horizontal & with a choice of access options to facilitate easy access for cleaning, blockage removal & effluent testing or to prevent unauthorised access.

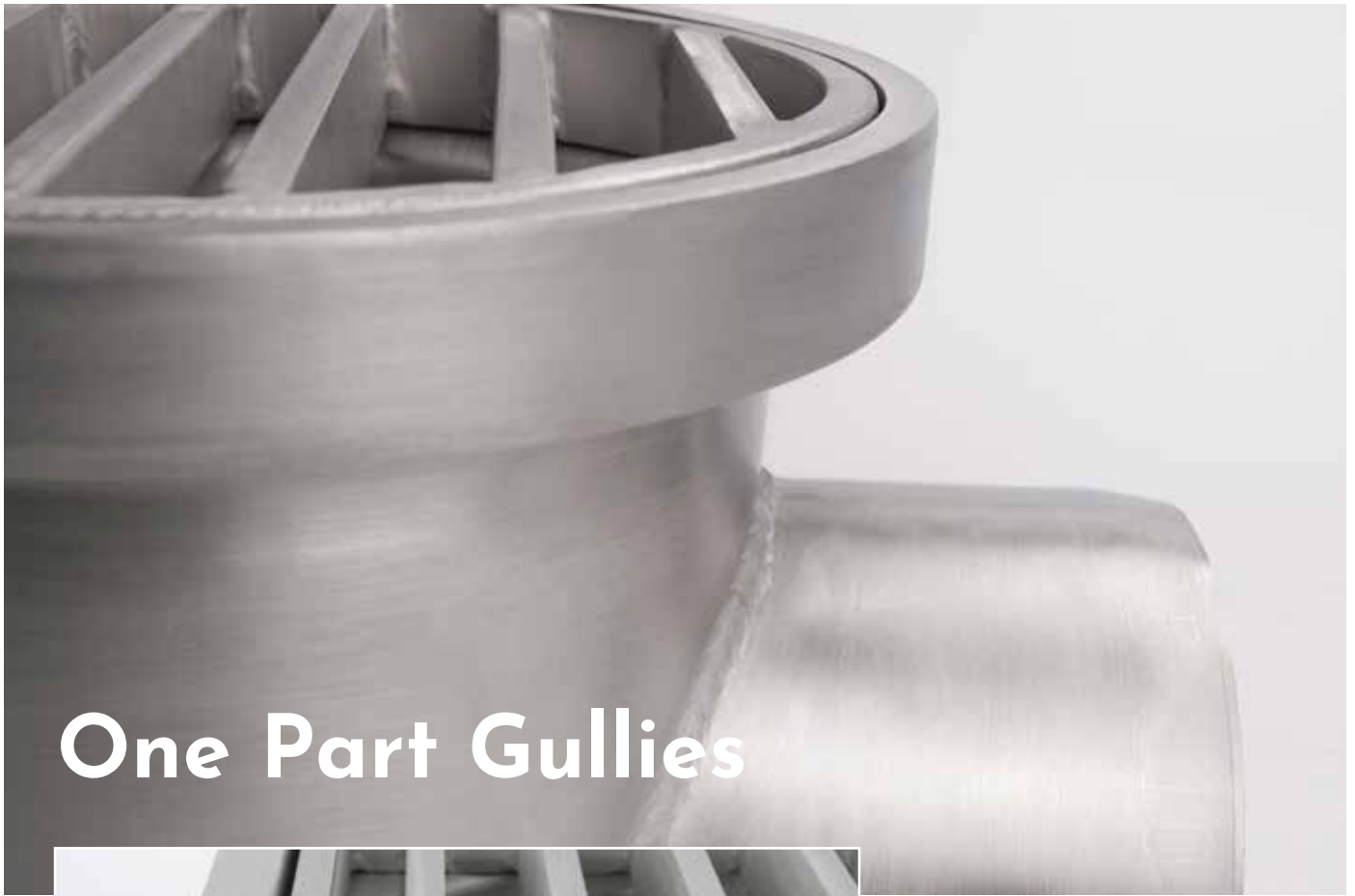

One Part Gullies



One Part Vertical Square Gully



- Available with square frame in 4 standard sizes.
- Vertical outlet.
- Available with Slip Resistant Mesh, Plain Ladder and Flat Plate covers.
- Available in 304 and 316 stainless steel.

Description

Suitable for use as point drainage or in conjunction with linear channels in all food, pharmaceutical and engineering environments. Complete with a vertical outlet and removable foul air trap and silt basket to facilitate easy cleaning.

Grade 304 stainless steel options are suitable for food & beverage production or preparation areas where the rapid removal of surface process liquids or cleaning water is required, such as commercial kitchens, dairies, abattoirs, dairies, bottling plants and distilleries etc.

Grade 316 stainless steel options are suitable for pharmaceutical, engineering and wastewater treatment facilities where particularly corrosive liquids are used or produced.

Technical description

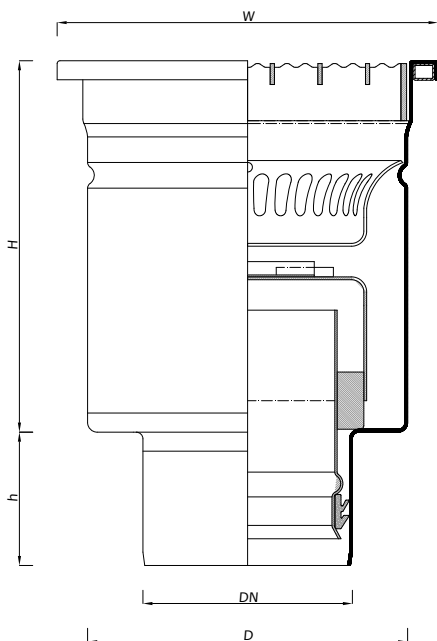

Options are available for other environments such as swimming pools, warehousing, car parking, domestic driveways etc

| Gully BK KRD | 200 | 250 | 300 | 400 |
|--------------|---------------|---------------|----------------------------|----------------------------|
| W | 200mm x 200mm | 250mm x 250mm | 300mm x 300mm | 400mm x 400mm |
| H | minimum 190mm | minimum 190mm | minimum 190mm | minimum 190mm |
| h | min. 70mm | min. 70mm | min. 70mm | min. 70mm |
| DN | 75mm/110mm | 75mm/110mm | 75mm/110mm/ 160mm/200mm | 75mm/110mm/ 160mm/200mm |
| D | 168mm | 168mm | 250mm | 350mm |



Slip Resistant Grating



Plain Ladder Grating



Flat Plate

Flange detail

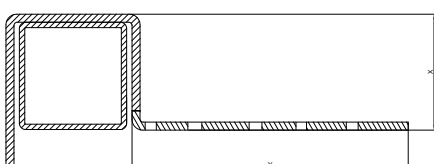

One Part Horizontal Square Gully



- Available with square frame in 4 standard sizes.
- Horizontal outlet.
- Available with Slip Resistant Mesh, Plain Ladder and Flat Plate covers.
- Available in 304 and 316 stainless steel.

Description

Suitable for use as point drainage or in conjunction with linear channels in all food, pharmaceutical and engineering environments. Complete with a horizontal outlet and removable foul air trap and silt basket to facilitate easy cleaning.

Grade 304 stainless steel options are suitable for food & beverage production or preparation areas where the rapid removal of surface process liquids or cleaning water is required, such as commercial kitchens, dairies, abattoirs, dairies, bottling plants and distilleries etc.

Grade 316 stainless steel options are suitable for pharmaceutical, engineering and wastewater treatment facilities where particularly corrosive liquids are used or produced.

Technical description

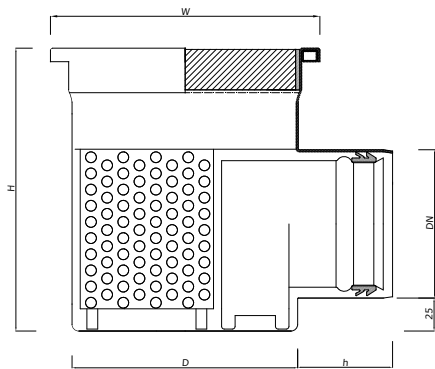

Options are available for other environments such as swimming pools, warehousing, car parking, domestic driveways etc

| Gully BK KRB | 200 | 250 | 300 | 400 |
|--------------|---------------|---------------|----------------------------|----------------------------|
| W | 200mm x 200mm | 250mm x 250mm | 300mm x 300mm | 400mm x 400mm |
| H | minimum 200mm | minimum 200mm | minimum 265mm | minimum 315mm |
| h | min. 70mm | min. 70mm | min. 70mm | min. 70mm |
| DN | 75mm/110mm | 75mm/110mm | 75mm/110mm/ 160mm/200mm | 75mm/110mm/ 160mm/200mm |
| D | 168mm | 168mm | 250mm | 350mm |

Flange detail

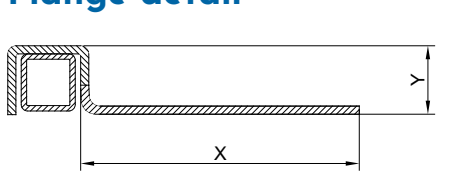

Slip Resistant Grating



Plain Ladder Grating



Plate Cover

One Part Hygienic Vertical Gully



- Available with square or round frame, in 2 standard sizes.
- Vertical outlet.
- Available with Flat Plate or Perforated Flat Plate covers
- Available in 304 and 316 stainless steel.

Description

Suitable for use as point drainage where it is an advantage to close the plate cover to prevent harmful liquids from entering the wastewater system. Complete with a vertical outlet and removable foul air trap and silt basket to facilitate easy cleaning.

Grade 304 stainless steel options are suitable for food & beverage production or preparation areas where the rapid removal of surface process liquids or cleaning water is required, such as commercial kitchens, dairies, abattoirs, dairies, bottling plants and distilleries etc.

Grade 316 stainless steel options are suitable for pharmaceutical, engineering and wastewater treatment facilities where particularly corrosive liquids are used or produced.

Options are available for other environments such as swimming pools, warehousing, car parking, domestic driveways etc

Technical description

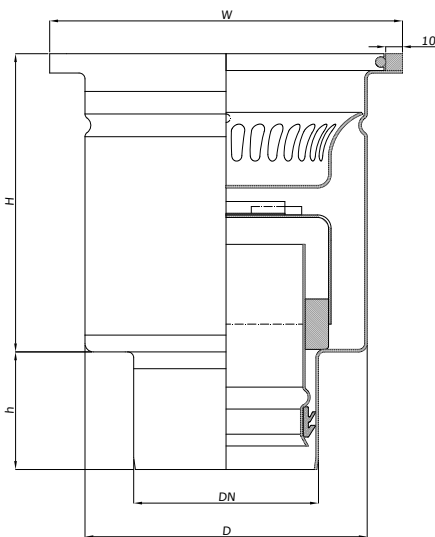

Flange detail

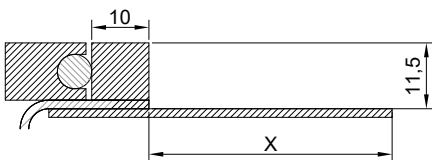

Flange for round top

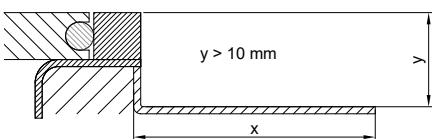

Flange for square top finishing

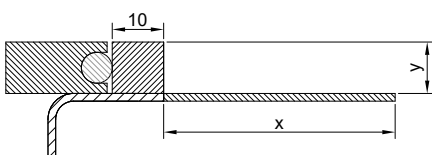

Flange for square top finishing

| Gully BK KRDO | Round 210 / Square 210 x 210 | Round 300 / Square 300 x 300 |
|---------------|------------------------------|------------------------------|
| W | 210mm | 300mm |
| H | minimum 190mm | minimum 190mm |
| h | min. 70mm | min. 70mm |
| DN | 75mm/110mm | 75mm/110mm/160mm |
| D | 168mm | 250mm |



Perforated Plate



Flat Plate

One Part Hygienic Horizontal Gully



- Available with square or round frame, in 2 standard sizes.
- Horizontal outlet.
- Available with Closable Flat Plate or Closable Perforated Plate covers.
- Available in 304 and 316 stainless steel.

Description

Suitable for use as point drainage where it is an advantage to close the plate cover to prevent harmful liquids from entering the wastewater system. Complete with a horizontal outlet and removable foul air trap and silt basket to facilitate easy cleaning.

Grade 304 stainless steel options are suitable for food & beverage production or preparation areas where the rapid removal of surface process liquids or cleaning water is required, such as commercial kitchens, dairies, abattoirs, dairies, bottling plants and distilleries etc.

Grade 316 stainless steel options are suitable for pharmaceutical, engineering and wastewater treatment facilities where particularly corrosive liquids are used or produced.

Options are available for other environments such as swimming pools, warehousing, car parking, domestic driveways etc

Technical description

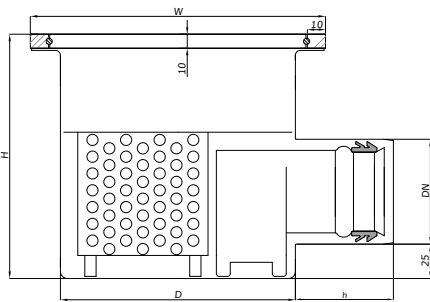

Flange detail

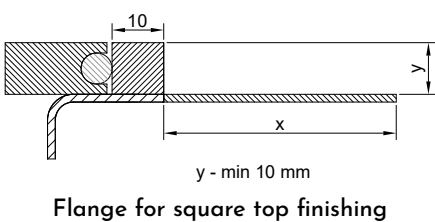
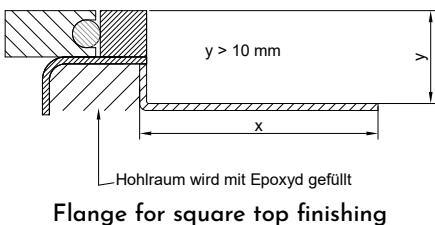
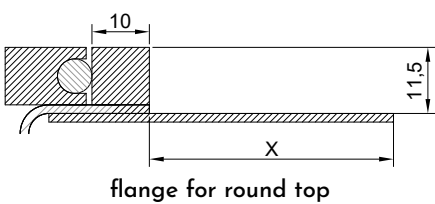

| Gully BK KRBO | Round 210 / Square 210 x 210 | Round 300 / Square 300 x 300 |
|---------------|------------------------------|------------------------------|
| W | 210mm | 300mm |
| H | minimum 200mm | minimum 265mm |
| h | min. 70mm | min. 70mm |
| DN | 75mm/110mm | 75mm/110mm/160mm |
| D | 168mm | 250mm |



Perforated Plate



Flat Plate

One Part Vertical Round Gully



- Available with round frame in 2 standard sizes.
- Vertical outlet.
- Available with Slip Resistant Mesh, Plain Ladder, Flat Plate and Closable Flat Plate covers.
- Available in 304 and 316 stainless steel.

Description

Suitable for use as point drainage or in conjunction with linear channels in all food and beverage, pharmaceutical and engineering environments. Complete with a vertical outlet and removable foul air trap and silt basket to facilitate easy cleaning.

Grade 304 stainless steel options are suitable for food & beverage production or preparation areas where the rapid removal of surface process liquids or cleaning water is required, such as commercial kitchens, dairies, abattoirs, dairies, bottling plants and distilleries etc.

Grade 316 stainless steel options are suitable for pharmaceutical, engineering and wastewater treatment facilities where particularly corrosive liquids are used or produced.

Technical description

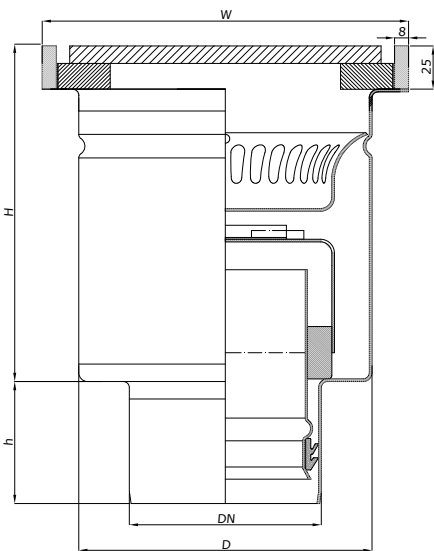

Options are available for other environments such as swimming pools, warehousing, car parking, domestic driveways etc

| Gully BK KROD | 210 | 300 |
|---------------|---------------|------------------|
| W | 210mm | 300mm |
| H | minimum 210mm | minimum 210mm |
| h | min. 70mm | min. 70mm |
| DN | 75mm/110mm | 75mm/110mm/160mm |
| D | 168mm | 250mm |

Flange detail

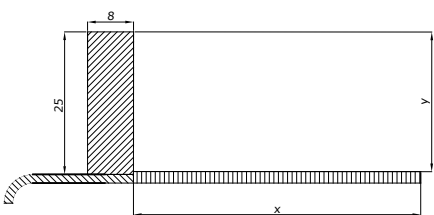

Fixed or perforated



Slip Resistant Grating



Plain Ladder Grating



Plate Cover



Closable Plate Cover

One Part Horizontal Round Gully



- Available with round frame in 2 standard sizes.
- Horizontal outlet.
- Available with Slip Resistant Mesh, Plain Ladder, Flat Plate and Closable Flat Plate covers.
- Available in 304 and 316 stainless steel.

Description

Suitable for use as point drainage or in conjunction with linear channels in all food and beverage, pharmaceutical and engineering environments. Complete with a horizontal outlet and removable foul air trap and silt basket to facilitate easy cleaning.

Grade 304 stainless steel options are suitable for food & beverage production or preparation areas where the rapid removal of surface process liquids or cleaning water is required, such as commercial kitchens, dairies, abattoirs, dairies, bottling plants and distilleries etc.

Grade 316 stainless steel options are suitable for pharmaceutical, engineering and wastewater treatment facilities where particularly corrosive liquids are used or produced.

Technical description

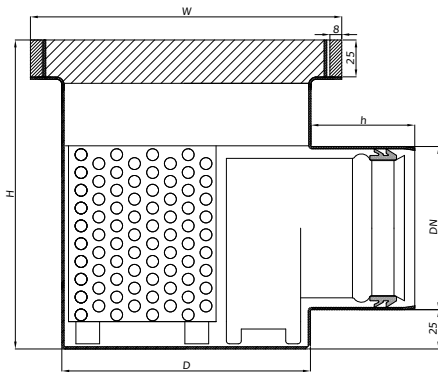

Options are available for other environments such as swimming pools, warehousing, car parking, domestic driveways etc

| Gully BK KROB | 210 | 300 |
|---------------|---------------|------------------|
| W | 210mm | 300mm |
| H | minimum 210mm | minimum 210mm |
| h | min. 70mm | min. 70mm |
| DN | 75mm/110mm | 75mm/110mm/160mm |
| D | 168mm | 250mm |

Flange detail

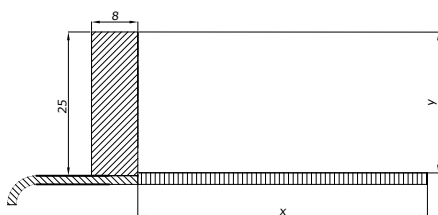

Fixed or perforated



Slip Resistant Grating



Plain Ladder Grating



Plate Cover

Rodding Eye



- Available with a square frame in 4 standard sizes.
- Vertical outlet.
- Complete with 4 fixing points.
- Available with Flat Plate, Chequer Plate and Tile Inset Covers.
- Available in 304 and 316 stainless steel.
- Includes rubber mounting gasket

Description

Rodding eyes are locked and sealed access covers installed downstream of drainage gullies, or at any convenient point in a drainage system, to facilitate easy access for cleaning, blockage removal and effluent testing..

Technical description

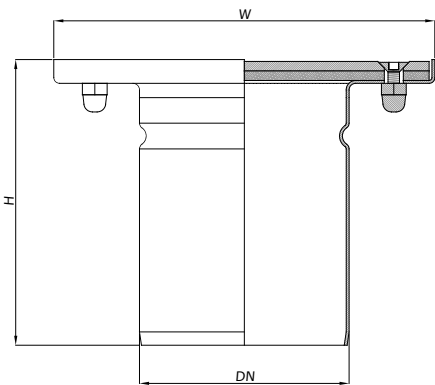

| BK RC Rodding eye | 150 | 200 | 250 | 300 |
|-------------------|---------------------|---------------------------|---------------------------|---------------------------------|
| W | 150mm x 150mm | 200mm x 200mm | 250mm x 250mm | 300mm x 300mm |
| H | minimum 150mm | minimum 150mm | minimum 150mm | minimum 150mm |
| DN | 50mm/75mm/ 110mm | 50mm/75mm/ 110mm/160mm | 50mm/75mm/ 110mm/160mm | 50mm/75mm/ 110mm/160mm/200mm |



Flat Plate Cover



Chequer Plate Cover



Tile Inset Cover

Lockable Vertical Round Gully



- Available with round frame in 1 standard size.
- Vertical outlet.
- Available with Slip Resistant Mesh, Plain Ladder and Closable Flat Plate covers.
- Available in 304 and 316 stainless steel.

Description

Lockable Round Gully to prevent unauthorised access.

Technical description

| Gully BK KROB LOCKABLE | 300 |
|------------------------|------------|
| W | 300mm |
| H | min. 202mm |
| h | min. 80mm |
| DN | 75mm/110mm |
| D | 250mm |

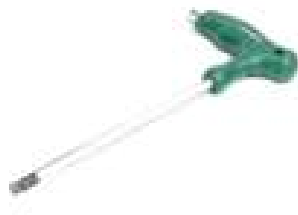
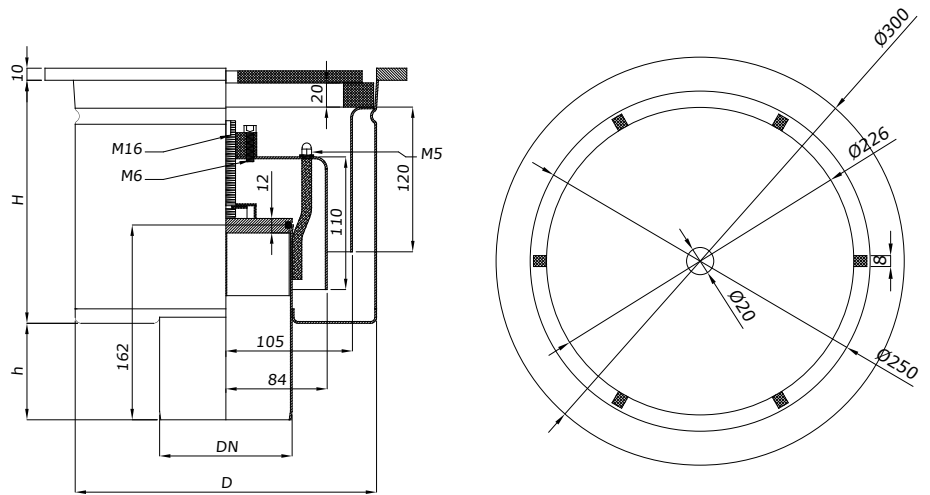

Locking Key



Slip Resistant Mesh Grating



Flat Plate Cover



Plain Ladder Grating

Lockable Vertical Square Gully



- Available with square frame in 1 standard size.
- Vertical outlet.
- Available with Slip Resistant Mesh, Plain Ladder and Flat Plate covers.
- Available in 304 and 316 stainless steel.

Description

Lockable Square Gully to prevent unauthorised access.

| Gully BK KROB LOCKABLE | 300 |
|------------------------|------------|
| W | 300mm |
| H | min. 202mm |
| h | min. 80mm |
| DN | 75mm/110mm |
| D | 250mm |

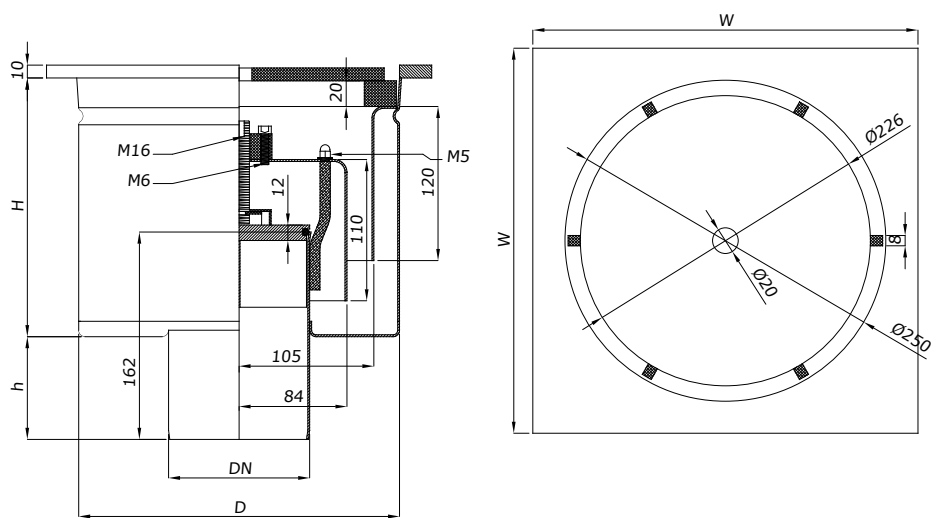

Locking Key



Flat Plate



Slip Resistant Grating



Plain Ladder Grating



Two Part Gullies



Two Part Vertical Square Gully



- Available in 4 standard sizes.
- Vertical outlet.
- Available with Slip Resistant Mesh, Plain Ladder, Flat Plate covers.
- Available in 304 and 316 stainless steel.

Description

Suitable for use as point drainage or in conjunction with linear channels in all food and beverage, pharmaceutical and engineering environments. Complete with a vertical outlet and removable foul air trap and silt basket to facilitate easy cleaning. Being two part, the invert depth is adjustable on site.

Technical description

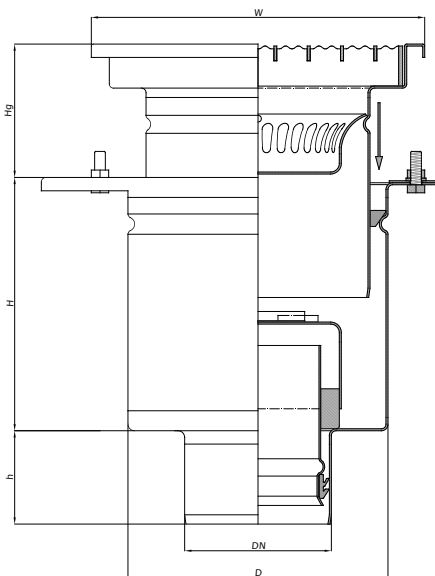

Grade 304 stainless steel options are suitable for food & beverage production or preparation areas where the rapid removal of surface process liquids or cleaning water is required, such as commercial kitchens, dairies, abattoirs, dairies, bottling plants and distilleries etc.

Grade 316 stainless steel options are suitable for pharmaceutical, engineering and wastewater treatment facilities where particularly corrosive liquids are used or produced.

Options are available for other environments such as swimming pools, warehousing, car parking, domestic driveways etc

| Gully BK KRD | 200 | 250 | 300 | 400 |
|--------------|------------------|------------------|------------------|------------------|
| W | 200mm x 200mm | 250mm x 250mm | 300mm x 300mm | 400mm x 400mm |
| Hg | 50-160 | 50-160 | 50-160 | 50-160 |
| H | minimum 150mm | minimum 200mm | minimum 265mm | minimum 315mm |
| h | min. 70mm | min. 70mm | min. 70mm | min. 70mm |
| DN | 75mm/110mm/160mm | 75mm/110mm/160mm | 75mm/110mm/160mm | 75mm/110mm/160mm |
| D | 195mm | 195mm | 250mm | 350mm |

Flange detail

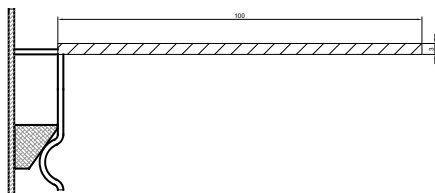

Lower part fixed flange

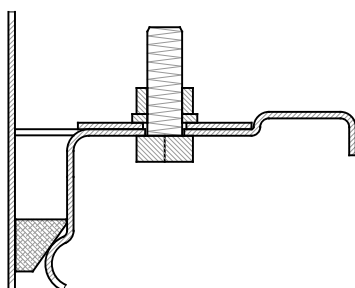

Lower part pressing flange



Slip Resistant Grating



Plain Ladder Grating



Flat Plate

Two Part Vertical Round Gully



- Available in 2 standard sizes.
- Vertical outlet.
- Available with Slip Resistant Mesh, Plain Ladder, Flat Plate covers.
- Available in 304 and 316 stainless steel.

Description

Suitable for use as point drainage or in conjunction with linear channels in all food, pharmaceutical and engineering environments. Complete with a vertical outlet and removable foul air trap and silt basket to facilitate easy cleaning. Being two part, the invert depth is adjustable on site.

Grade 304 stainless steel options are suitable for food & beverage production or preparation areas where the rapid removal of surface process liquids or cleaning water is required, such as commercial kitchens, dairies, abattoirs, dairies, bottling plants and distilleries etc.

Grade 316 stainless steel options are suitable for pharmaceutical, engineering and wastewater treatment facilities where particularly corrosive liquids are used or produced.

Options are available for other environments such as swimming pools, warehousing, car parking, domestic driveways etc

Technical description

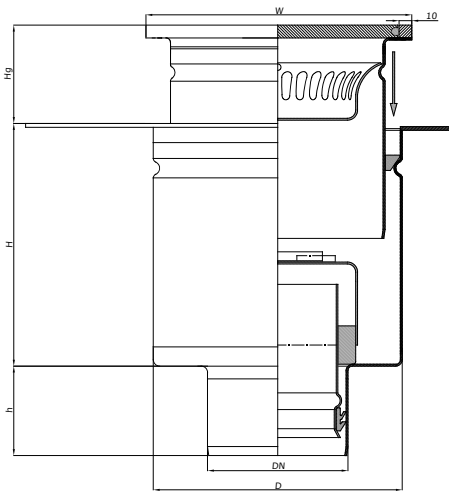

Flange detail

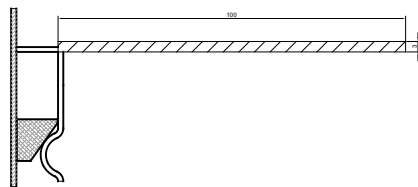
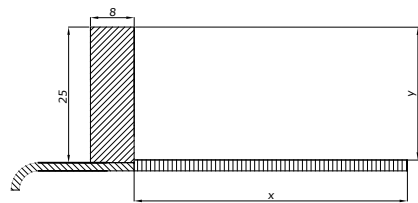

Lower part fixed flange

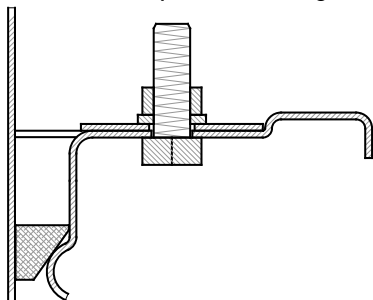

Lower part pressing flange

| Gully BK KROD | 210 | 300 |
|---------------|------------------|------------------|
| W | 210mm | 300mm |
| Hg | 50-160 | 50-160 |
| H | minimum 210mm | minimum 210mm |
| h | min. 70mm | min. 70mm |
| DN | 75mm/110mm/160mm | 75mm/110mm/160mm |
| D | 195mm | 250mm |



Plain Ladder Grating



Slip Resistant Grating



Flat Plat



Closeable Flat Plate

Two Part Horizontal Gully



- Available with square or round frame in 4 standard sizes.
- Horizontal outlet.
- Available with Slip Resistant Mesh, Plain Ladder, Flat Plate covers.
- Available in 304 and 316 stainless steel.

Description

Suitable for use as point drainage or in conjunction with linear channels in all food, pharmaceutical and engineering environments. Complete with a horizontal outlet and removable foul air trap and silt basket to facilitate easy cleaning. Being two part, the invert depth is adjustable on site.

Technical description

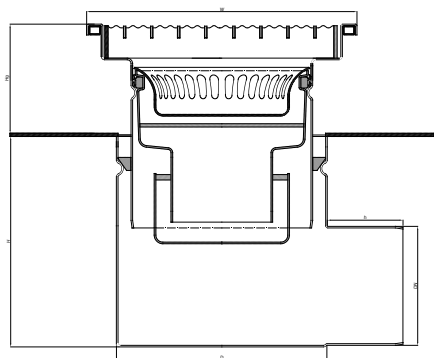

Grade 304 stainless steel options are suitable for food & beverage production or preparation areas where the rapid removal of surface process liquids or cleaning water is required, such as commercial kitchens, dairies, abattoirs, dairies, bottling plants and distilleries etc.

Grade 316 stainless steel options are suitable for pharmaceutical, engineering and wastewater treatment facilities where particularly corrosive liquids are used or produced.

Flange detail

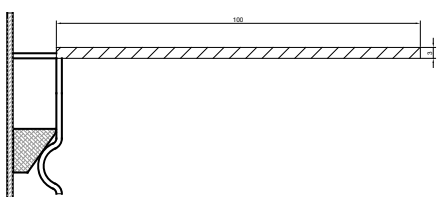
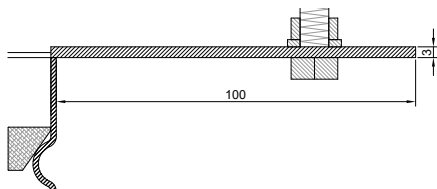

Lower part fixed flange

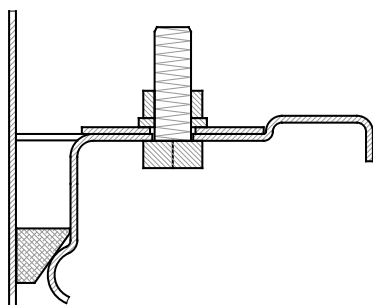

Lower part pressing flange

Options are available for other environments such as swimming pools, warehousing, car parking, domestic driveways etc

| Gully BK KRB | 200 | 250 | 300 | 400 |
|--------------|------------------|------------------|------------------|------------------|
| W | 200mm x 200mm | 250mm x 250mm | 300mm x 300mm | 400mm x 400mm |
| Hg | 50-160 | 50-160 | 50-160 | 50-160 |
| H | minimum 195mm | minimum 195mm | minimum 250mm | minimum 250mm |
| h | min. 70mm | min. 70mm | min. 70mm | min. 70mm |
| DN | 75mm/110mm/160mm | 75mm/110mm/160mm | 75mm/110mm/160mm | 75mm/110mm/160mm |
| D | 195mm | 195mm | 250mm | 350mm |



Slip Resistant Grating



Plain Ladder Grating



Flat Plate

Two Part Hygienic Vertical Gully



- Available with square or round frame, in 2 standard sizes.
- Vertical Outlet.
- Available with Closable Flat Plate or Perforated Flat Plate covers.
- Available in 304 and 316 stainless steel.

Description

Suitable for use as point drainage or in conjunction with linear channels in all food, pharmaceutical and engineering environments. Complete with a vertical outlet and removable foul air trap and silt basket to facilitate easy cleaning. Being two part, the invert depth is adjustable on site.

Technical description

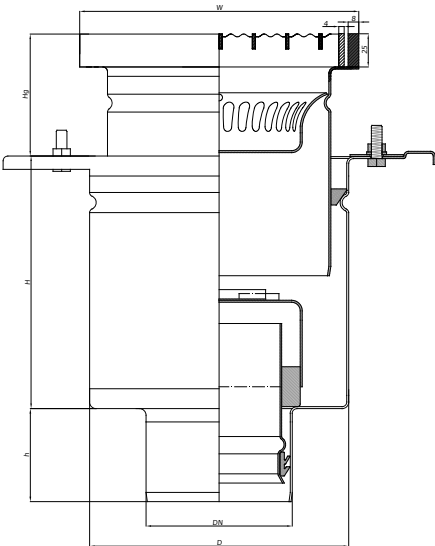

Grade 304 stainless steel options are suitable for food & beverage production or preparation areas where the rapid removal of surface process liquids or cleaning water is required, such as commercial kitchens, dairies, abattoirs, dairies, bottling plants and distilleries etc.

Grade 316 stainless steel options are suitable for pharmaceutical, engineering and wastewater treatment facilities where particularly corrosive liquids are used or produced.

Options are available for other environments such as swimming pools, warehousing, car parking, domestic driveways etc

Flange detail

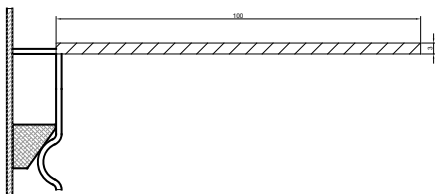

Lower part fixed flange

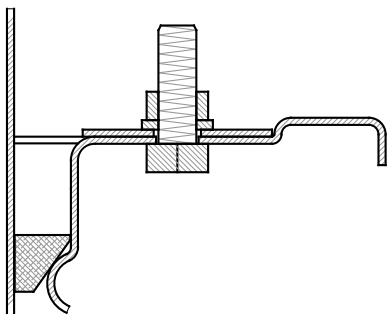

Lower part pressing flange

| Gully BK KRDO | Round 210 / Square 210 x 210 | Round 300 / Square 300 x 300 |
|---------------|------------------------------|------------------------------|
| W | 210mm | 300mm |
| Hg | 50-160 | 50-160 |
| H | minimum 210mm | minimum 210mm |
| h | min. 70mm | min. 70mm |
| DN | 75mm/110mm/160mm | 75mm/110mm/160mm |
| D | 195mm | 250mm |



Perforated Plate



Flat Plate

Two Part Hygienic Horizontal Gully



- Available with square or round frame, in 2 standard sizes.
- Horizontal Outlet.
- Closable Flat Plate or Closable Perforated Flat Plate covers available.
- Available in 304 and 316 stainless steel.

Description

Suitable for use as point drainage where it is an advantage to close the plate cover to prevent harmful liquids from entering the wastewater system. Complete with a horizontal outlet and removable foul air trap and silt basket to facilitate easy cleaning. Being two part, the invert depth is adjustable on site.

Grade 304 stainless steel options are suitable for food & beverage production or preparation areas where the rapid removal of surface process liquids or cleaning water is required, such as commercial kitchens, dairies, abattoirs, dairies, bottling plants and distilleries etc.

Grade 316 stainless steel options are suitable for pharmaceutical, engineering and wastewater treatment facilities where particularly corrosive liquids are used or produced.

Options are available for other environments such as swimming pools, warehousing, car parking, domestic driveways etc

Technical description

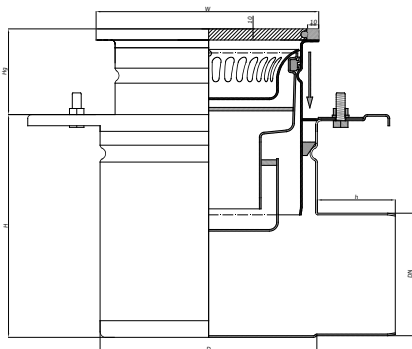

Flange detail

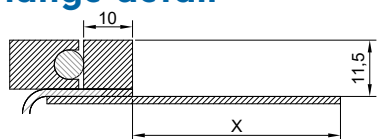

Flange for round top

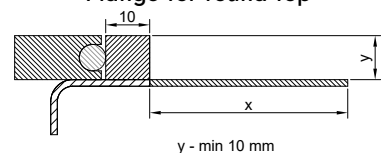

Flange for square top finishing

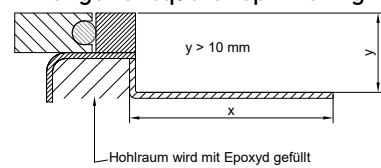

Flange for square top finishing

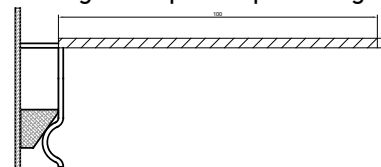

Lower part fixed flange

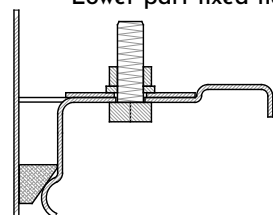

Lower part pressing flange

| Gully BK KRBO | Round 210 / Square 210 x 210 | Round 300 / Square 300 x 300 |
|---------------|------------------------------|------------------------------|
| W | 210mm | 300mm |
| Hg | 50-160 | 50-160 |
| H | minimum 210mm | minimum 210mm |
| h | min. 70mm | min. 70mm |
| DN | 75mm/110mm/160mm | 75mm/110mm/160mm |
| D | 195mm | 250mm |



Perforated Plate



Flat Plate

Two Part Rodding Eye



- Available with square frame in 4 standard sizes.
- Vertical outlet.
- Available with Flat Plate, Chequer Plate and Tile Inset covers.
- Available in 304 and 316 stainless steel.
- Includes rubber mounting gasket

Technical description

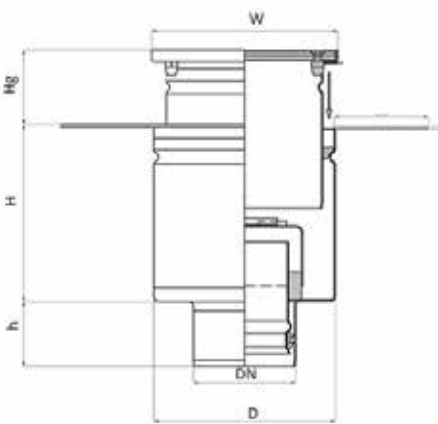

Description

Rodding eyes are locked and sealed access covers installed downstream of drainage gullies, or at any convenient point in a drainage system, to facilitate easy access for cleaning, blockage removal and effluent testing.

| BK RC Inspection / Rodding eye | 150 | 200 | 250 | 300 |
|--------------------------------|-----------------|-----------------|-----------------------|-----------------------------|
| W | 150mm x 150mm | 200mm x 200mm | 250mm x 250mm | 300mm x 300mm |
| Hg | 50-160 | 50-160 | 50-160 | 50-160 |
| H | minimum 150mm | minimum 150mm | minimum 150mm | minimum 150mm |
| DN | 50mm/75mm/110mm | 50mm/75mm/110mm | 50mm/75mm/110mm/160mm | 50mm/75mm/110mm/160mm/200mm |
| D | 195mm | 135mm | 250mm | 350mm |

Flange detail

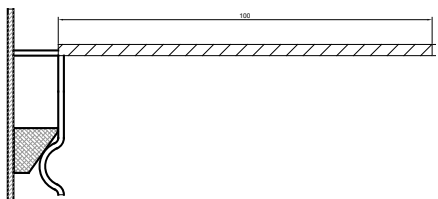

Lower part fixed flange

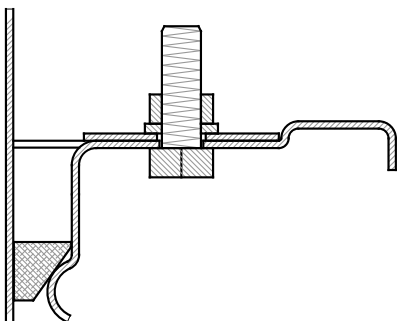

Lower part pressing flange



Flat Plate



Tile Inset Cover



Chequer Plate Cover



Silt Basket Horizontal



Silt Basket Vertical

Silt trap

Silt traps are provided within drainage gullies to capture solid particles suspended in process fluids or cleaning water to prevent their entry into the drainage system. Silt traps are easily removable, and their robust construction allows for regular emptying and easy cleaning. Available in 304 or 316 grade stainless steel as appropriate to the conditions, silt traps are designed and manufactured in the appropriate shape and size to fit any sized gully with either a horizontal or vertical outlet.



Foul Air Trap Horizontal



Foul Air Trap Vertical



Lockable Siphon

Foul Air trap

Foul air traps, commonly referred to as water traps, form an effective seal in any drainage gully, allowing process fluids and cleaning water to exit the gully, whilst preventing odours and associated airborne bacterial contamination from emanating from the foul water system. Designed and manufactured to fit the appropriate gully size and horizontal or vertical outlet, our foul air traps are designed with rounded corners to enable rapid and easy cleaning.



Floor Pans



Floor Pans



- Designed & manufactured to site specific customer requirements.
- Available with High Strength Slip Resistant Mesh, Plain Ladder and Plate covers.
- Available with Silt Baskets and Foul Air Trap
- Available in 304 and 316 stainless steel.

Description

Floor Pans are designed to accept large volumes of water, for example where boiling pans are discharged, or as disinfection baths for pedestrian footwear and/or, trolley or vehicle wheels. Either single or two-part options are available to provide additional fixing flexibility on site. When gratings are necessary, they are provided in a higher gauge profile to accommodate the wider spans.

Technical description

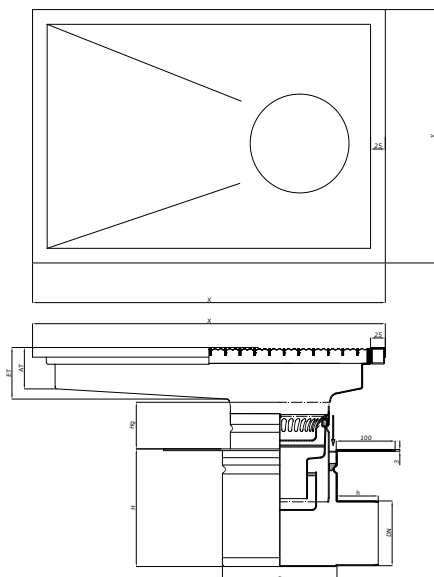
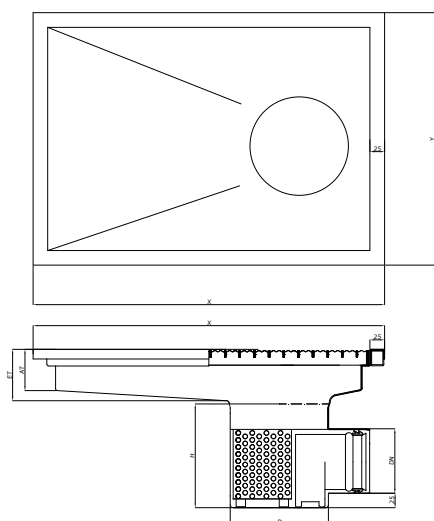

| | Floor Pan KRB | Floor Pan KRD |
|----|-------------------|-------------------|
| X | customer order | customer order |
| Y | customer order | customer order |
| H | min. 220mm | min. 210mm |
| h | min. 70mm | min. 70mm |
| D | 168mm/250mm/350mm | 168mm/250mm/350mm |
| DN | 75mm/110mm/160mm | 75mm/110mm/160mm |
| AT | min 45mm | min 50mm |
| ET | customer order | customer order |



One Part Floor Pan



Two Part Floor Pan

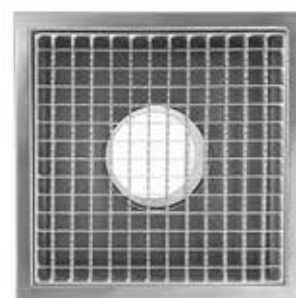

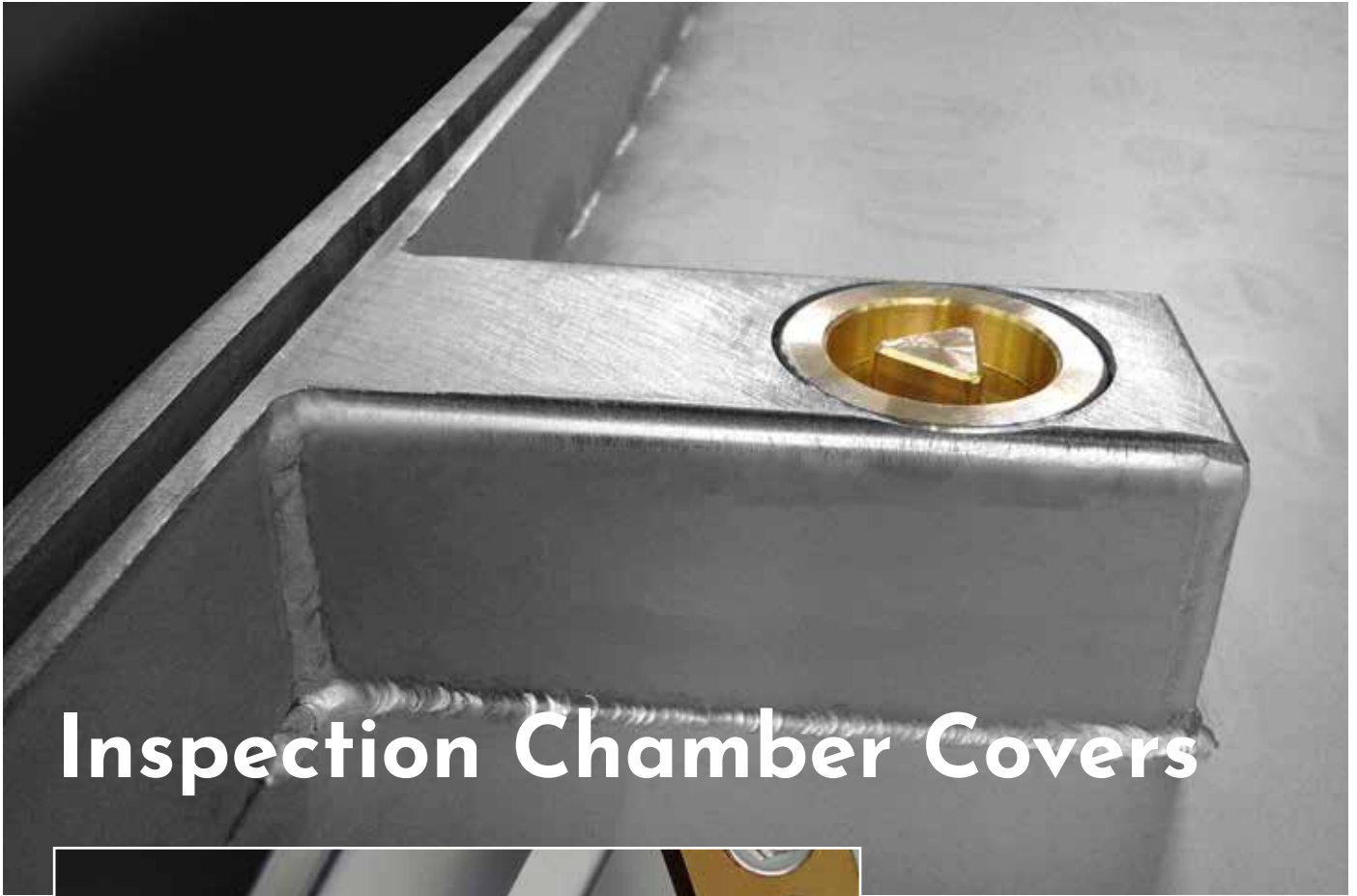

Inspection Chamber Covers



Inspection Chamber Covers

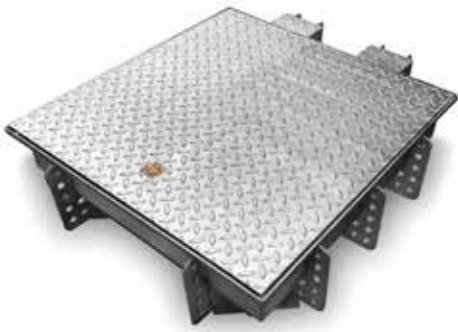

- Designed & manufactured to site specific customer requirements.
- Robust Neoprene Gasket Seal preventing odour escape.
- Available with Chequer Plate or Recessed cover.
- Heavy duty gas struts for easy and safe opening.
- Lockable to prevent unauthorised entry.

Description

Flush mounted chamber covers are designed for a wide range of industries and purposes.

Suitable for settling tank, foul drainage and cable chambers in food and pharmaceutical factories, engineering, airports, petrol stations & waste water treatment etc.

Technical description

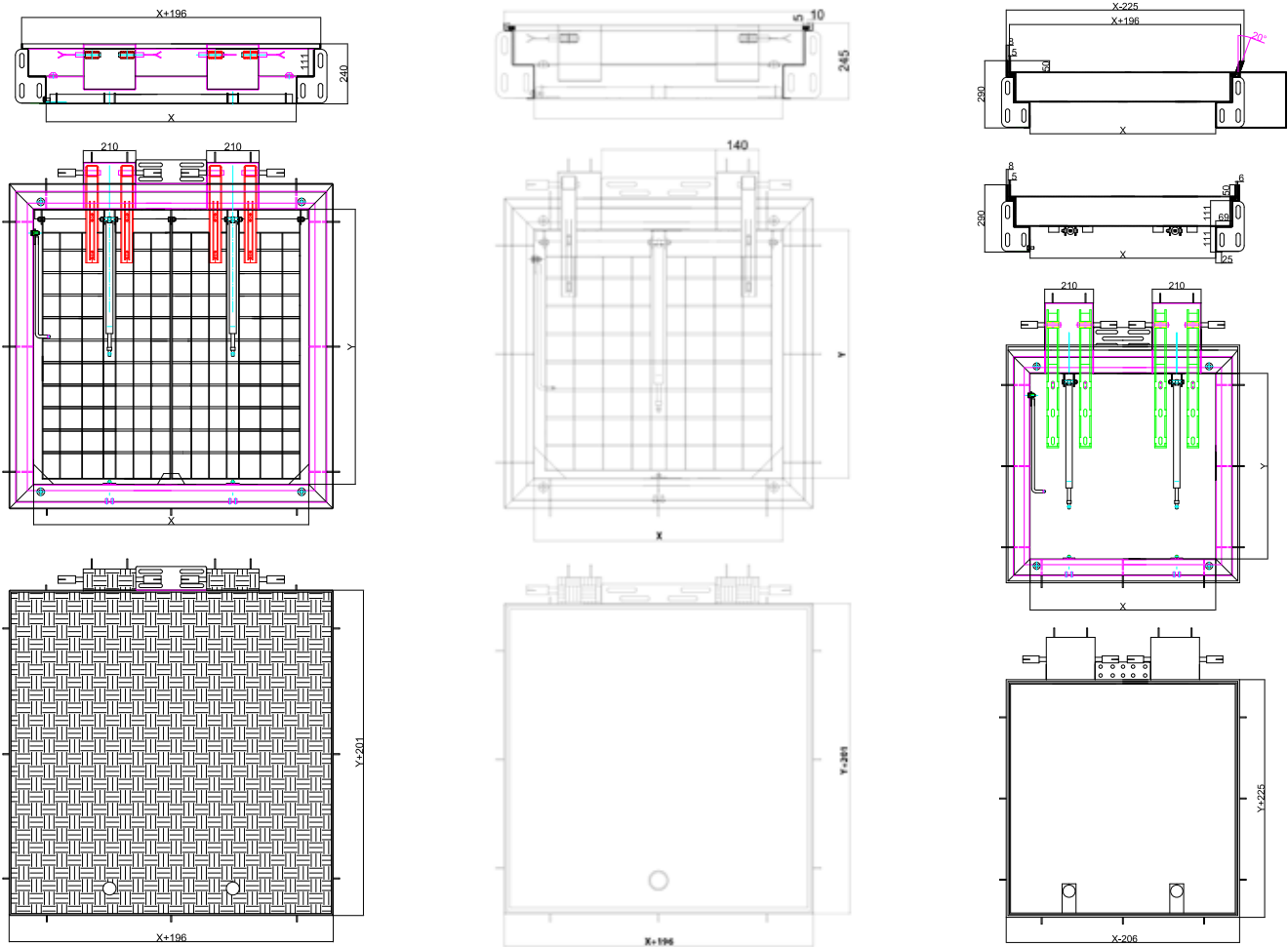

Recessed Cover



Chequer Plate Cover



Available in both 304 and 316 grades to site-specific customer design, stainless steel baths are available for a broad range of purposes in the food, pharmaceutical, chemical, agriculture and mining industries

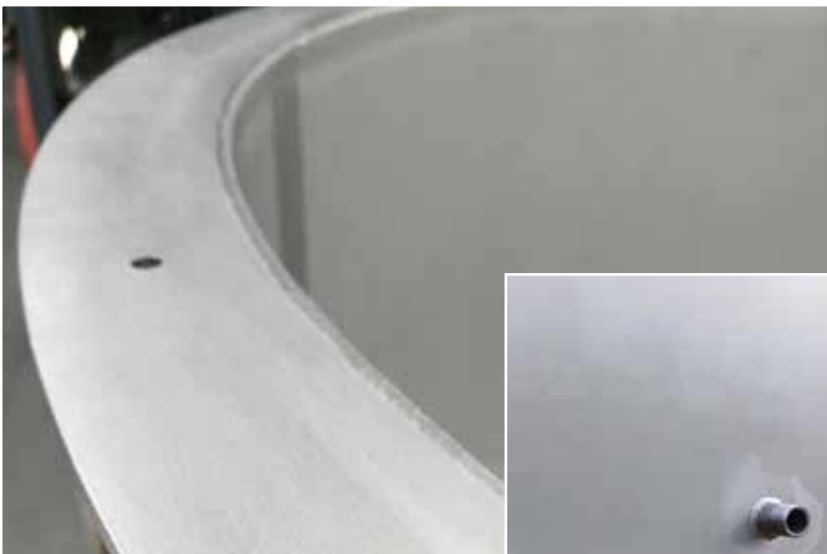



Stainless Steel Furniture



Stainless Steel Furniture



- Designed for hygienic, easy cleaned use.
- Available in 304 and 316 stainless steel.

Description

A range of fully welded bespoke furniture & industrial components for commercial kitchens, food, pharmaceutical & engineering factories etc. All items designed and manufactured to customer requirements, including bump rails, balustrading, kerbs & coving, cooling racks, sink units, preparation tables, shelving units, presentation and serving counters, lockers etc.





BK AQUADRAIN



info@bkaquadrain.co.uk

0114 553 9593